

An eco-friendly and  
secure investment!

**ctc**  
HEAT PUMPS

# CTC EcoZenith i360 II

Ultra-efficient indoor module for plenty of hot water.

9-12 kW, models H and L

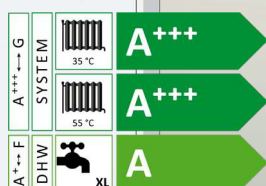
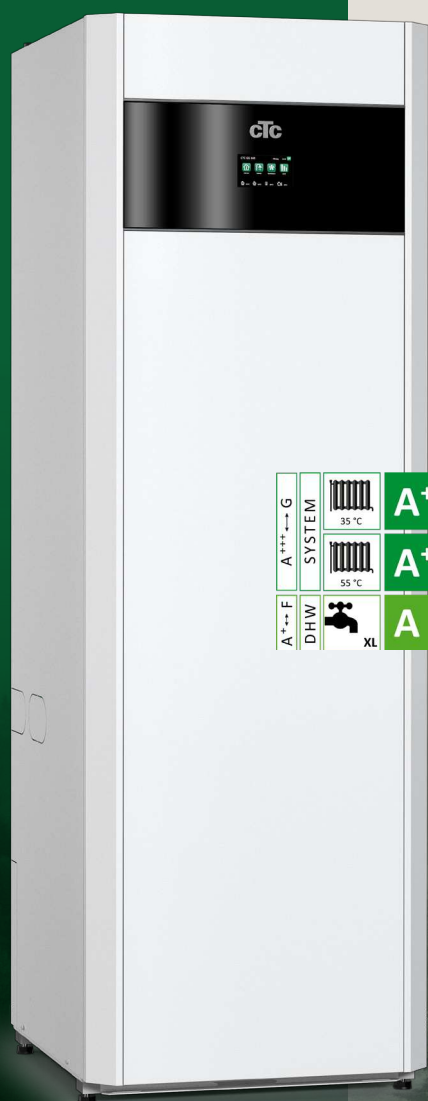

- Smart and user-friendly
- All-inclusive with minimal energy losses
- Low ceiling height? No problem!
- Climate-controlled and expandable
- Plenty of hot water
- 18-litre expansion vessel

Find a CTC distributor in your country - [www.ctc-heating.com](http://www.ctc-heating.com)



MADE IN SWEDEN

# CTC EcoZenith i360 is equipped with an efficient flow-through DHW heater. When combined with CTC EcoAir or CTC EcoPart, it can produce over 300 litres of hot water.

## A complete heat pump

CTC EcoZenith i360 has a stylish design, integrated display and high-quality finish! The design of your new indoor module allows it to become a stylish part of your interior, wherever you choose to install it.

With the integrated touch screen, CTC EcoZenith i360 has a user-friendly interface where you can easily access all functions and can both swipe and scroll, just like on your smartphone. In addition, you can easily mirror the display on your tablet, mobile, etc.

The colour touch screen has clear symbols and the option to switch languages, making it easy to adjust the heating and hot water or to retrieve a wealth of operating data.

CTC EcoZenith i360 is an ultra-efficient

indoor module with built-in heat pump control. Install it together with CTC EcoAir air-to-water heat pumps for the perfect combination. For those who would prefer ground source heating, CTC EcoPart is the ideal choice.

## All-inclusive with minimal energy losses

The expansion tank, supply cable and primary flow sensor are all factory-fitted. In addition, the manometer and automatic bleeders come as standard. CTC EcoZenith i360 is well-insulated and therefore has minimal energy losses.

## Low ceiling height? No problem!

Choose the height of the indoor module that suits your home. It is available in two heights: 1666 or 1924 mm. The low height model has pipe connections at the top while the taller model connects at the bottom.

## Climate-controlled and expandable

The built-in shunt-automatics is climate-controlled and takes into account both internal and external temperatures. CTC EcoZenith i360 is able to control two individual heating systems as standard.

By using various accessories, you can easily add solar heating, or let a water-jacketed stove or your existing water boiler contribute heat. Or why not connect a pool so you can also enjoy the warmth in summer?

## Smartgrid and ready for the future

CTC EcoZenith i360 has internet connectivity as standard so that you can easily control your product remotely using the myUplink app. It is also equipped to connect to Alexa, Google Home and the future power grid (SmartGrid).

Technical data 400 V		i360 H 3N~	i360 L 3N~
CTC-no.		590941001	590940001
Weight (packaged weight)	kg	156 (185)	145 (172)
Dimensions (depth x width x height)	mm	673 x 596 x 1867	673 x 596 x 1669
Required ceiling height	mm	1928	1669
Kv value – product (1Bar Δp)		2.7	2.6
Sound power L <sub>WA</sub> B0/W35 (EN 12102)	dB(A)	15	
Electrical data, connection		400V 3N~ 50Hz	
Rated power	kW	12.2	
Rated current (recommended fuse)	A	19 (20)	
Max. immersion heater output at group fuse: 10/13/16/20/25 A	kW	3.5 / 6.1 / 8.4 / 9.9 / 11.9	
Ingress Protection class (IP)		IP X1	
Output range immersion heater (min-max)	kW	0.5 - 11.9	
Max. operating pressure: Heating system (PS)	bar	3.0	
Max. operating pressure: DHW system	bar	10	
Water volume: Heating system (V)	litres	225	
Water volume: DHW system	litres	1.7	
DHW performance V <sub>40</sub> Economy/Normal/Comfort (EN 16147)	litres	210 / 235 / 304	
Package efficiency class: W35/55 (A+++ to G) <sup>1)</sup>		A+++ / A+++	
Energy efficiency class DHW (A+ to F) / charge profile (EN16147) <sup>1)</sup>		A / XL	

<sup>1)</sup> CTC EcoZenith is only approved for installation together with heat pumps in accordance with the EU Ecodesign Directive. The data provided is applicable together with CTC EcoPart 612M. Energy labels and data sheets can be downloaded from [www.ctc-heating.com/ecodesign](http://www.ctc-heating.com/ecodesign)



## Dimensions diagram

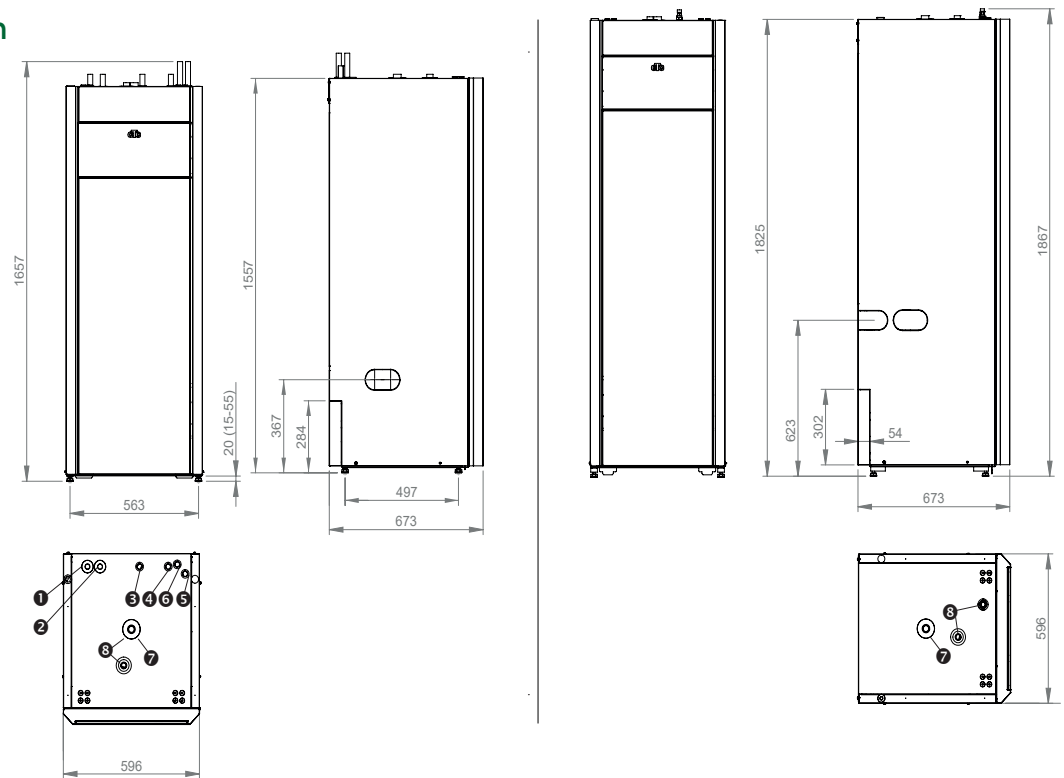

1. Cold water Ø22
2. DHW Ø22
3. Return flow Ø22
4. Primary flow Ø22
5. To heat pump Ø22
6. From heat pump Ø22
7. Expansion /Lifting sleeve ¾"
8. Automatic bleeders ½"

### Delivery includes:

Indoor module with manual, factory-fitted charge pump, supply cable and expansion vessel.

### Packaging includes:

Room sensor, outdoor sensor, automatic vent valve, filling valve, current sensor, heating circuit safety valve (2.5 bar), filter ball valve with magnet for the return heating circuit, pressure gauge, dirt filter for cold water, and drainage valve.

Technical data 230 V		i360 L 1N~	i360 L 3~
CTC-no.		590940002	590940003
Weight (packaged weight)	kg	145 (172)	145 (172)
Dimensions (depth x width x height)	mm	673 x 596 x 1669	673 x 596 x 1669
Required ceiling height	mm	1669	1669
K <sub>v</sub> value – product (1Bar Δp)		2.6	2.6
Sound power L <sub>WA</sub> B0/W35 (EN 12102)	dB(A)	15	15
Electrical data, connection		230V 1N~ 50Hz	230V 3~ 50Hz
Rated power	kW	9.3	10.3
Rated current (recommended fuse)	A	41 (50)	27 (32)
Max. immersion heater output at group fuse: 20/25/32/35/50/63 A	kW	3.8 / 5.2 / 6.7 / 7.5 / 9 / 9	5 / 7.5 / 10 / 10 / 10 / 10
Ingress Protection class (IP)		IP X1	IP X1
Output range immersion heater (min-max)	kW	0.3 - 9.0	2.5 - 10.0
Max. operating pressure: Heating system (PS)	bar	3.0	3.0
Max. operating pressure: DHW system	bar	10	10
Water volume: Heating system (V)	litres	225	225
Water volume: DHW system	litres	1.7	1.7
DHW performance V <sub>40</sub> Economy/Normal/Comfort (EN 16147)	litres	210 / 235 / 304	210 / 235 / 304
Package efficiency class: W35/55 (A+++ to G) <sup>1)</sup>		A+++ / A+++	A+++ / A+++
Energy efficiency class DHW (A+ to F) / charge profile (EN16147) <sup>1)</sup>		A / XL	A / XL



info@ctc.se

+46 372 88 000

P.O Box 309 SE-341 26 Ljungby Sweden



# Compatible heat pumps

– refer to individual product sheets for more detailed information.



CTC EcoAir 700M



CTC EcoAir 406-408, 510M-622M



CTC CombiAir



CTC EcoPart 406-412, 612M-616M

# Smart accessories

– supplement and simplify.

		CTC no.:
CTC Charge Pump 25/6.0-130	Additional circulation pump/radiator pump	588892301
CTC Expansion Energyflex II	External control of solar/pool/DHW circulation, etc.	589262301
CTC Diverting Valve, 3-way	For interconnections in the system, e.g. pool (22 mm connection)	583621401
CTC EcoVent 25	Exhaust air unit - Adapted for placement above the heat pump	589701001
CTC EcoComfort	A passive cooling unit that uses the borehole's cool temperature	585920001
CTC Through-flow heater 11.9 kW	INCOLOY - for areas where there are problems with high chloride levels	589595302
CTC Housing cover high	480 mm. Hide pipe connections, etc. with a stylish housing cover	589442301
CTC Housing cover low	146 mm. Hide pipe connections, etc. with a stylish housing cover	589440301
CTC Housing cover medium	380 mm. Hide pipe connections, etc. with a stylish housing cover	589441301
CTC DHW button	Activates the extra hot water function, wire-bound	582515301
CTC SmartControl Gateway	Base unit able to control up to seven optional units	588300301
CTC SmartControl Repeater	Amplifies the signal between the base unit and the different accessories	588300302
CTC SmartControl Room/Humidity/CO <sub>2</sub> sensor	Wired sensor that can control ventilation on demand (Base unit required)	588300303
CTC SmartControl Room/Humidity Sensor	Solar powered and wireless with rechargeable battery (Base unit required)	588305301
CTC SmartControl Room Sensor	Solar powered and wireless with rechargeable battery (Base unit required)	588306301
CTC SmartControl Multi-button	Wireless 2 mode button (Base unit required)	588307301
CTC Solar Pump Station	Compact solar pump station for solar heating	587700001
CTC Start-kit EcoSol	Start kit for connecting CTC solar control with existing solar system	587458301
CTC Current Sensor, 1-pack	For monitoring the building's main fuses (I360 L 1x230V)	908453001